

2013 PRE-DELIVERY SERVICE CHECK SHEET

| BEFORE INSPECTION | OK | Adjust/ Repair |
|---|--------------------------|--------------------------|
| 01 Install Short Pin* (Hawaii, Puerto Rico, Saipan, Guam, American Samoa) | <input type="checkbox"/> | |
| FUNCTIONAL OPERATION | | |
| <i>Apply parking brake and cycle ignition "IG-ON"; place gear selector in reverse; turn on lights and rear defogger. Unlock doors; release fuel door.</i> | | |
| 01 Check dome, courtesy, map, and sun visor lights* | <input type="checkbox"/> | <input type="checkbox"/> |
| 02 Check warning/indicator lights, gauges, and horn | <input type="checkbox"/> | <input type="checkbox"/> |
| 03 Check windshield wipers and washers | <input type="checkbox"/> | <input type="checkbox"/> |
| 04 Check headlights, instrument lights, turn signals, emergency flashers, and brake lights | <input type="checkbox"/> | <input type="checkbox"/> |
| 05 Check inside/outside rear view mirror operation/adjustment* | <input type="checkbox"/> | <input type="checkbox"/> |
| 06 Check cigarette lighter* and power outlets | <input type="checkbox"/> | <input type="checkbox"/> |
| 07 Check audio/navigation*/backup camera* systems and set clock | <input type="checkbox"/> | <input type="checkbox"/> |
| 08 Verify Entune/Navigation software version (Display Audio, Non-HDD Type only)* | <input type="checkbox"/> | <input type="checkbox"/> |
| 09 Check sliding roof* | <input type="checkbox"/> | <input type="checkbox"/> |
| 10 Install shift-lock override button cover | <input type="checkbox"/> | |
| WALKAROUND INSPECTION | | |
| <i>Start at left front door. Check window and door lock operation (from master power switch, if equipped). Continue around vehicle in a counterclockwise direction checking each door and window operation, child door locks, seat belts, interior condition, all lights, luggage compartment contents. Finish by checking headlight aim and continue into UNDER HOOD checks.</i> | | |
| 01 Check Smart Key System* | <input type="checkbox"/> | <input type="checkbox"/> |
| 02 Check door and door lock operation, including each wireless remote control/theft deterrent system* | <input type="checkbox"/> | <input type="checkbox"/> |
| 03 Check window operation | <input type="checkbox"/> | <input type="checkbox"/> |
| 04 Check that engine starts with all keys | <input type="checkbox"/> | <input type="checkbox"/> |
| 05 Check that child safety door locks are in normal (unlocked) position | <input type="checkbox"/> | <input type="checkbox"/> |
| 06 Check seats and seat belt operation | <input type="checkbox"/> | <input type="checkbox"/> |
| 07 Check rear defogger/rear view mirror defogger* | <input type="checkbox"/> | <input type="checkbox"/> |
| 08 Check side marker, tail, backup, and license plate lights | <input type="checkbox"/> | <input type="checkbox"/> |
| 09 Check luggage compartment light* and trim appearance | <input type="checkbox"/> | <input type="checkbox"/> |
| 10 Adjust spare tire pressure, inspect for damage, and check jack and tool installation | <input type="checkbox"/> | <input type="checkbox"/> |
| 11 Check headlight aim | <input type="checkbox"/> | <input type="checkbox"/> |
| UNDER HOOD | | |
| 01 Check engine oil level and ATM fluid levels | <input type="checkbox"/> | <input type="checkbox"/> |
| 02 Check brake fluid level | <input type="checkbox"/> | <input type="checkbox"/> |
| 03 Check engine coolant level | <input type="checkbox"/> | <input type="checkbox"/> |
| 04 Check windshield washer fluid level | <input type="checkbox"/> | <input type="checkbox"/> |
| 05 Check battery state-of-charge using Digital Battery System Analyzer (SOC Reading: _____%) | <input type="checkbox"/> | <input type="checkbox"/> |
| 06 Inspect for fuel, oil, coolant, and other fluid leaks | <input type="checkbox"/> | <input type="checkbox"/> |
| * Inspect or install when equipped/required. | | |

| UNDER VEHICLE (ON HOIST) | OK | Adjust/ Repair |
|--|--------------------------|--------------------------|
| 01 Remove disc brake anti-rust covers/anti-corrosion wheel film* | <input type="checkbox"/> | |
| 02 Inspect tires for defects/damage | <input type="checkbox"/> | <input type="checkbox"/> |
| 03 Verify Tire Pressure Warning System (TPWS) operation - see page 2 | <input type="checkbox"/> | <input type="checkbox"/> |
| 04 Install wheel covers/caps/spare tire wheel covers* | <input type="checkbox"/> | |
| 05 Inspect for fuel, oil, coolant, and other fluid leaks | <input type="checkbox"/> | <input type="checkbox"/> |
| 06 Inspect under the vehicle for damage, rust, etc. | <input type="checkbox"/> | <input type="checkbox"/> |
| 07 Visually check bolts and nuts on chassis and powertrain for looseness | <input type="checkbox"/> | <input type="checkbox"/> |
| 08 Install rubber body plugs (stored in glove box or center console)* | <input type="checkbox"/> | <input type="checkbox"/> |
| 09 Install front wheel opening extension pads - see page 2 | <input type="checkbox"/> | |
| ROAD TEST | | |
| <i>A complete road test helps assure customer satisfaction. Drive vehicle over a variety of road surfaces and driving conditions. Check for unusual noise and driving performance.</i> | | |
| Enter Odometer Readings | | |
| Reading Before Test: _____ Reading After Test: _____ | | |
| 01 Check cold engine operation | <input type="checkbox"/> | <input type="checkbox"/> |
| 02 Check engine operation during warm-up | <input type="checkbox"/> | <input type="checkbox"/> |
| 03 Check engine at normal operating temperature | <input type="checkbox"/> | <input type="checkbox"/> |
| 04 Check transmission operation | <input type="checkbox"/> | <input type="checkbox"/> |
| 05 Check brake and parking brake operation | <input type="checkbox"/> | <input type="checkbox"/> |
| 06 Check steering operation & off-center/vehicle pull/flutter. | <input type="checkbox"/> | <input type="checkbox"/> |
| 07 Inspect for abnormal noise and vibration | <input type="checkbox"/> | <input type="checkbox"/> |
| 08 Inspect for squeaks and rattles | <input type="checkbox"/> | <input type="checkbox"/> |
| 09 Check Blind Spot Monitor System* | <input type="checkbox"/> | <input type="checkbox"/> |
| 10 Check front and rear* heater and A/C operation | <input type="checkbox"/> | <input type="checkbox"/> |
| 11 Check cruise control operation* | <input type="checkbox"/> | <input type="checkbox"/> |
| 12 Check front seat heater/ventilation operation* | <input type="checkbox"/> | <input type="checkbox"/> |
| 13 Set/calibrate compass* - see page 2 | <input type="checkbox"/> | |
| FINAL INSPECTION AND CLEANING | | |
| 01 Remove interior protective covers, unnecessary labels, tags, etc. (Remove just before delivery to customer) | <input type="checkbox"/> | |
| 02 Visually inspect all interior parts for installation, damage, fit, dirt, etc. | <input type="checkbox"/> | <input type="checkbox"/> |
| 03 Verify floor mat application and install using retaining clips* | <input type="checkbox"/> | |
| 04 Verify green light is illuminated on SOS (Safety Connect) button* | <input type="checkbox"/> | |
| 05 Remove Rappgard™ and clear protective bumper film* | <input type="checkbox"/> | |
| 06 Wash and clean vehicle | <input type="checkbox"/> | |
| 07 Inspect paint finish for scratches, chips, rust, dents, damage, etc. | <input type="checkbox"/> | <input type="checkbox"/> |
| 08 Inspect exterior body parts for proper installation, damage, rust, etc. | <input type="checkbox"/> | <input type="checkbox"/> |
| 09 Place oil change sticker on inside of windshield, top left corner | <input type="checkbox"/> | |
| 10 Place Owner's Guide & first aid kit portfolio* in glove box | <input type="checkbox"/> | |
| 11 Perform Techstream Health Check | <input type="checkbox"/> | <input type="checkbox"/> |
| 12 Install front license plate & mounting bracket* - see page 2 | <input type="checkbox"/> | |

Completion and retention of this form is required to comply with Toyota's Warranty Policy.

TECHNICIAN'S SIGNATURE _____

SERVICE MANAGER'S SIGNATURE _____

NAME (PLEASE PRINT) _____

NAME (PLEASE PRINT) _____

We hereby certify that all items on this form have been checked and corrected for proper operation as required.

| | | | |
|------|-------------|-------------|---|
| Date | Dealer Name | Dealer Code | Vehicle Identification Number (Sticker) |
|------|-------------|-------------|---|

FRONT WHEEL OPENING EXTENSION PAD INSTALLATION

The front wheel opening extension pad set (right and left front wheel opening extension pads and 2 tapping screws) is loaded in the luggage compartment at the assembly plant to avoid damage in transit.

1. Remove the 2 tapping screws from the engine under cover (the screws will be reused for installation).
2. Place the left front wheel opening extension pad on the installation position as shown and tighten the 3 tapping screws.

NOTE

- There is a distinguishable mark on each pad.
- Do not interchange the tapping screws A and B.

3. Repeat steps 1 & 2 for the right side.

Tapping screws A:

Nominal length: 23.0 mm (0.91 in.)

Diameter: 6.0 mm (0.24 in.)

Washer outside diameter: 18.0 mm (0.71 in.)

Tapping screws B:

Nominal length: 16.0 mm (0.63 in.)

Diameter: 6.0 mm (0.24 in.)

Washer outside diameter: 20.0 mm (0.79 in.)

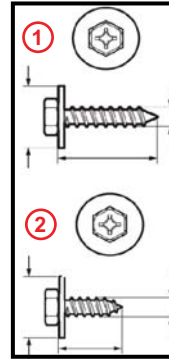

1 Screw A
2 Screw B

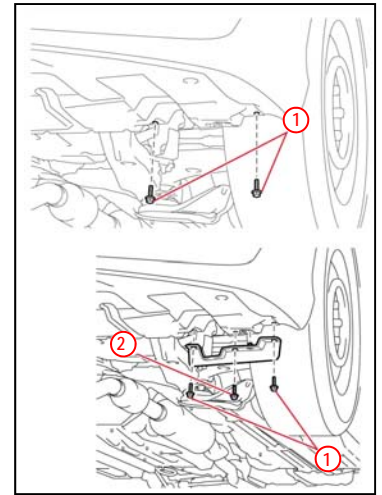

COMPASS CALIBRATION

Refer to the Repair Manual for the [Calibration procedure](#) for vehicles equipped with a compass in the rear view mirror.

NOTE

- Do NOT perform calibration of the compass in a place where the earth's magnetic field is subject to interference (underground parking, under a steel tower, between buildings, roof parking, near a railroad crossing, near a large vehicle, etc.).
- During calibration, do NOT operate electric systems (moon roof, power windows, etc.) as they may interfere with the calibration.

TPWS OPERATION VERIFICATION

1. Connect Techstream to DLC3.
2. Adjust all tires (except the spare tire) to the standard tire inflation pressure, as indicated on the tire and loading information label on vehicle.

NOTE

- To adjust the tire pressure correctly when outside temperature is significantly colder or warmer than shop temperature, follow the procedures outlined in Service Bulletin [T-SB-0020-12](#), "Tire Inflation Pressure Compensation and Adjustment".
- Adjust the tire pressure when the tires are cold.

3. Cycle the ignition switch to the "IG-ON" mode.
4. Check the tire pressure of all tires using Techstream. If the tire pressure values cannot be displayed, the system is not operating properly. Refer to the Repair Manual.

NOTE

If the tire pressure values are not properly displayed (i.e., showing N/A) the data from the transmitter has not been received.

5. Remove the ID number labels that are attached to each wheel and discard.

FRONT LICENSE PLATE & MOUNTING BRACKET* INSTALLATION

*There are two types of brackets. Type A (P/N 52114-06160) for Base, LE and XLE models. Type B (P/N 52114-06170) for SE models.

Installation Procedure

1. Insert the front license plate into the mounting bracket.
2. Align the center tab on the mounting bracket with the center line of the air intake.
3. **Type A (Base, LE, XLE) - P/N 52114-06160**
Attach the hooks of the mounting bracket to the second air intake opening and rotate the bracket upwards.
Type B (SE) - P/N 52114-06170
Attach the hooks of the mounting bracket to the top air intake opening and rotate bracket upwards.
4. Align the installation holes on the mounting bracket and front license plate with the dimples on the front bumper.
5. Screw in the 2 self-tapping screws directly into the dimples to install the front license plate and mounting bracket.

NOTICE

- Do NOT pre-drill holes into the bumper.
- Do NOT over-tighten the self-tapping screws.

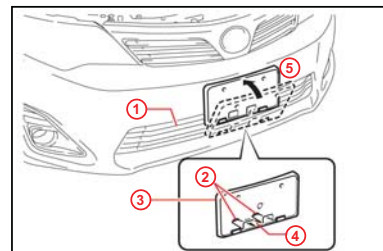

1 Air Intake
2 Hooks
3 Front License Plate Mounting Bracket
4 Tab
5 Rotate Bracket

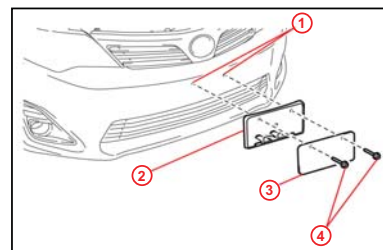

1 Dimples
2 Front License Plate Mounting Bracket
3 License Plate
4 Self-tapping Screws