

# Power Function of Sliding Door Inoperative

**Service Category** Vehicle Exterior

**Section** Door/Hatch

**Market** USA

Toyota Supports  
 ASE Certification 

## Applicability

YEAR(S)	MODEL(S)	ADDITIONAL INFORMATION
2004 – 2010	Sienna	

### REVISION NOTICE

**October 25, 2017 Rev2:**

- Applicability has been updated to include 2008 – 2010 model year Sienna vehicles.
- The Production Change Information section has been removed.
- The Parts Information and Repair Procedure sections have been updated.

**February 17, 2012 Rev1:**

- This Service Bulletin has been updated to include a Supersession Notice.

**Any previous printed versions of this service bulletin should be discarded.**

### SUPERSESSION NOTICE

**The information contained in this bulletin supersedes SB No. EL004-04.**

- Applicability has been updated to include 2005 – 2010 model year Sienna vehicles.

**Service Bulletin No. EL004-04 is obsolete and any printed versions should be discarded. Be sure to review the entire content of this service bulletin before proceeding.**

## Introduction

Some 2004 – 2010 model year Sienna vehicles may exhibit a condition where the power function of the sliding door is inoperative. A new service part has been developed so that the replacement of the entire motor/cable assembly is not required. Follow the Repair Procedure in this bulletin to address this condition.

## Power Function of Sliding Door Inoperative

### Warranty Information

OP CODE	DESCRIPTION	TIME	OFF	T1	T2
EL8048	R & R Power Slide Door Motor Replace Pulley/Cable Assembly (Right Side)	4.2	69631-08031	72	12
EL8049	R & R Power Slide Door Motor Replace Pulley/Cable Assembly (Left Side)	4.2	69641-08031		

#### APPLICABLE WARRANTY

- This repair is covered under the Toyota Comprehensive Warranty. This warranty is in effect for 36 months or 36,000 miles, whichever occurs first, from the vehicle's in-service date.
- Warranty application is limited to occurrence of the specified condition described in this bulletin.

### Parts Information

PREVIOUS PART NUMBER	CURRENT PART NUMBER	PART NAME	QTY
69631-08030	69631-08031	Control, Slide Door Attachment, RH	1
69641-08030	69641-08031	Control, Slide Door Attachment, LH	1

### Repair Procedure

1. Remove the power slide door motor assembly from the door.

Refer to the Technical Information System (TIS), applicable model and model year Repair Manual:

- [2004](#) / [2005](#) Sienna:  
*Vehicle Exterior – Door/Hatch – “Power Slide Door: Overhaul”*
- [2006](#) / [2007](#) Sienna:  
*Vehicle Exterior – Door/Hatch – “Engine Hood/Door: Power Slide Door: Disassembly”*
- [2008](#) / [2009](#) / [2010](#) Sienna:  
*Vehicle Exterior – Door/Hatch – “Engine Hood/Door: Slide Door (w/Power Slide Door): Disassembly”*

Figure 1.

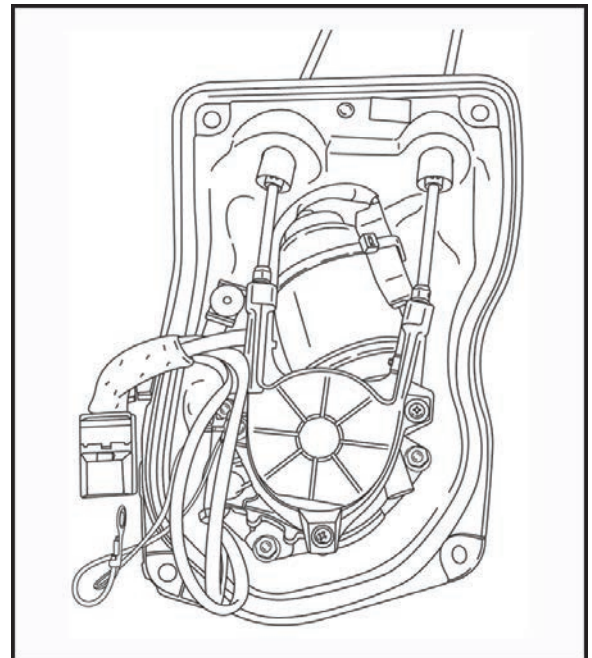

## Power Function of Sliding Door Inoperative

### Repair Procedure (Continued)

2. Remove the three collared screws from the actuator cover.

**Figure 2.**

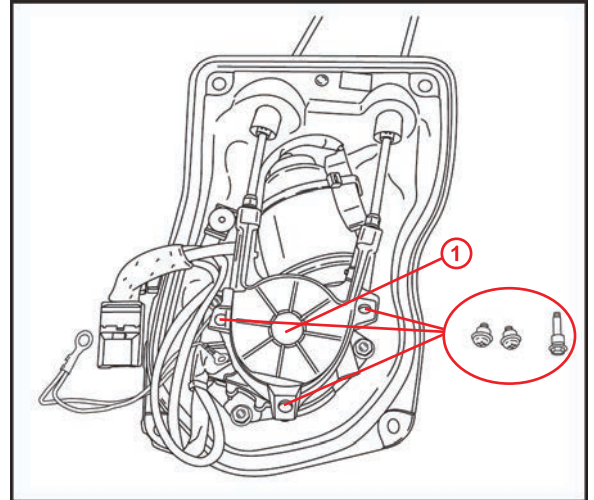

<b>1</b>	<b>Actuator Cover</b>
----------	-----------------------

3. Detach the connector housing from the bracket.

**Figure 3.**

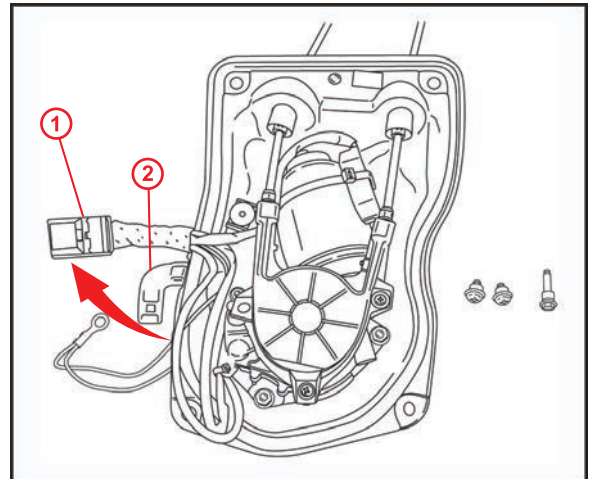

<b>1</b>	<b>Connector</b>
<b>2</b>	<b>Bracket</b>

## Power Function of Sliding Door Inoperative

### Repair Procedure (Continued)

4. Remove the three nuts that hold the motor onto the actuator cover, and separate the motor sub-assembly from the actuator.

**Figure 4.**

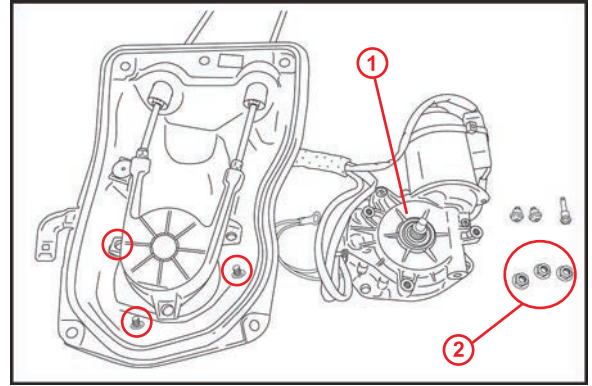

<b>1</b>	<b>Motor Sub-assembly</b>
<b>2</b>	<b>Nuts</b>

5. Slide the actuator cover out of the slide door attachment control.

**Figure 5.**

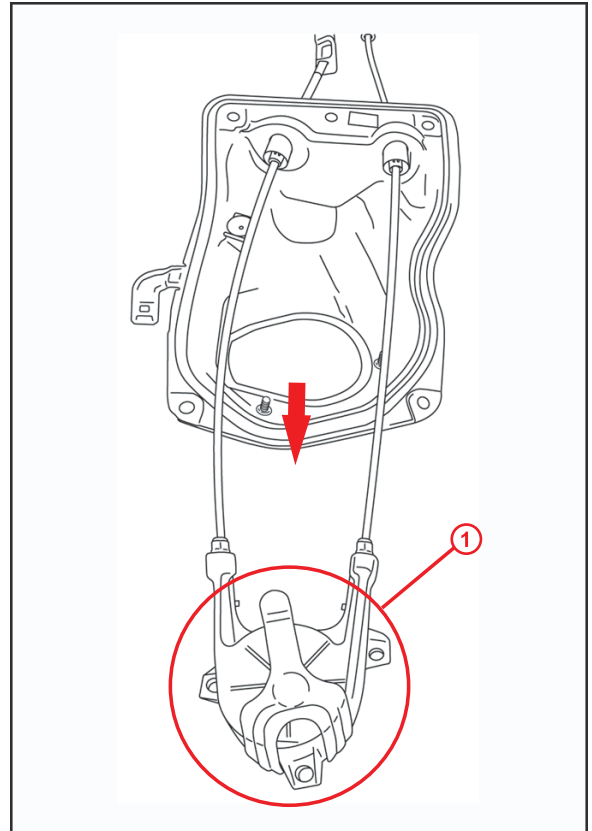

<b>1</b>	<b>Actuator Cover</b>
----------	-----------------------

## Power Function of Sliding Door Inoperative

---

### Repair Procedure (Continued)

6. Flip the actuator cover over.

**Figure 6.**

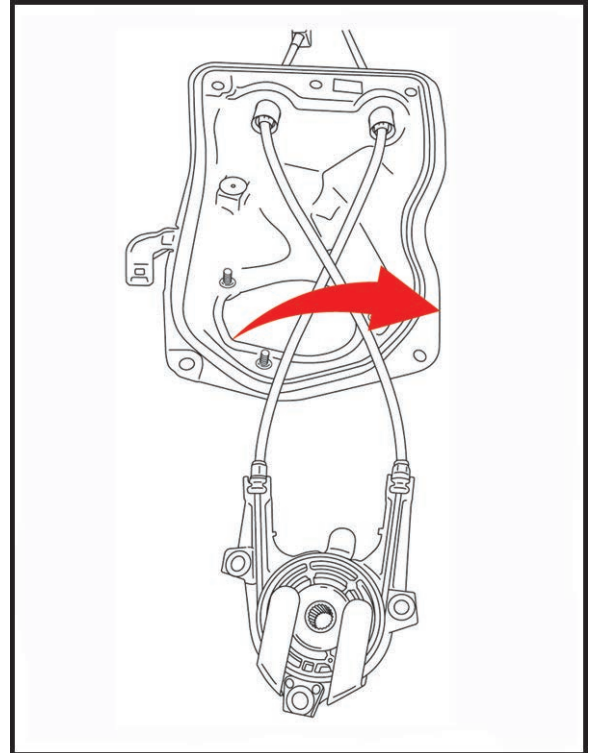

## Power Function of Sliding Door Inoperative

### Repair Procedure (Continued)

7. Reinsert the shaft of the original motor sub-assembly onto the NEW actuator cover.

**Figure 7.**

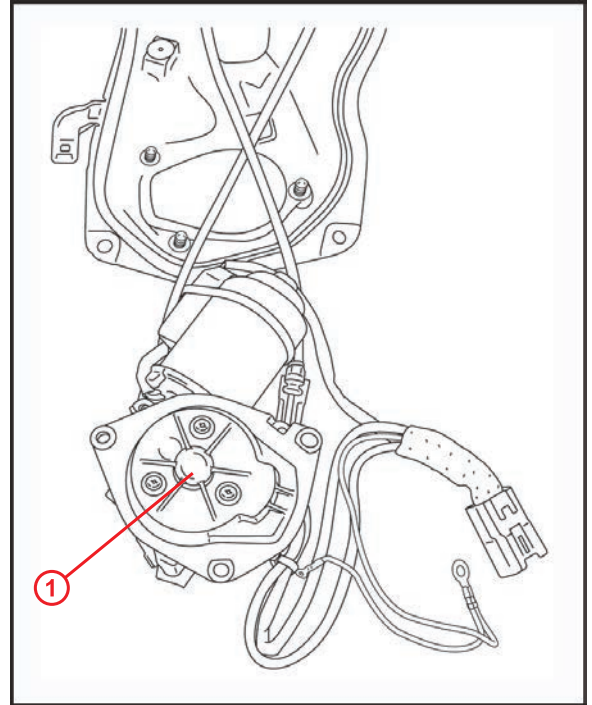

<b>1</b>	<b>Motor Sub-assembly</b>
----------	---------------------------

8. Flip the NEW actuator cover/motor assembly over.

**HINT**  
Do NOT allow the components to separate.

**Figure 8.**

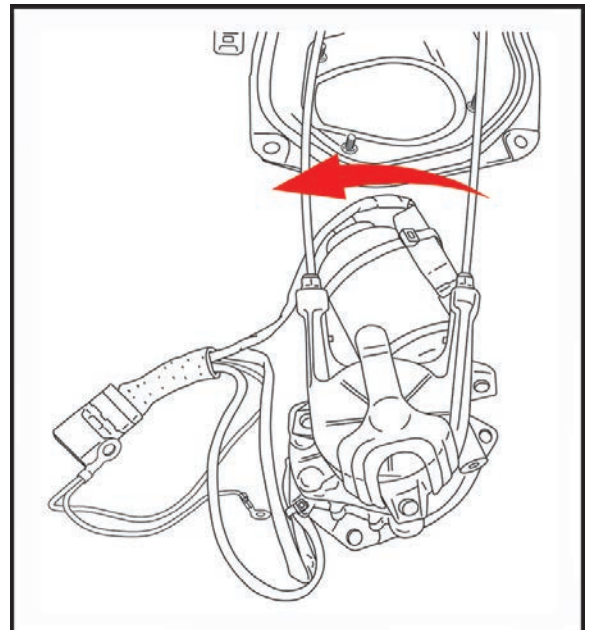

## Power Function of Sliding Door Inoperative

### Repair Procedure (Continued)

9. Secure the NEW actuator cover onto the motor assembly.
  - A. Lift up on (1) to pull toward (2) to remove the fork jig.
  - B. Push the actuator cover down at (3) until it contacts the motor sub-assembly.
  - C. Continue to hold the actuator cover until the screws have been reinstalled.

**NOTICE**

If the pulley comes loose or comes out of the actuator cover or the cable is removed, a NEW slide door attachment control will need to be ordered.

Figure 9.

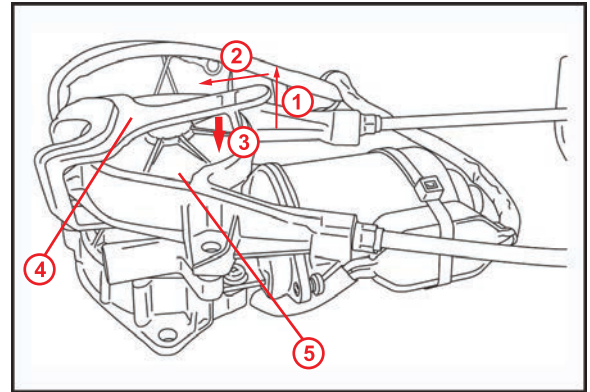

1	Lift Direction
2	Pulling Direction
3	Push Down
4	Fork Jig
5	Actuator Cover

## Power Function of Sliding Door Inoperative

### Repair Procedure (Continued)

10. Reinstall the actuator cover screws.

**HINT**

- Screw "A" is short and **MUST** have a collar and the ground wire attached to it.
- Screw "B" is long and **MUST** have a collar.
- Screw "C" is short and **MUST** have a collar.  
Torque: 1.4 N\*m (140 kgf\*cm, 12 in\*lbf)
- Continue to hold the actuator cover onto the motor.

Figure 10.

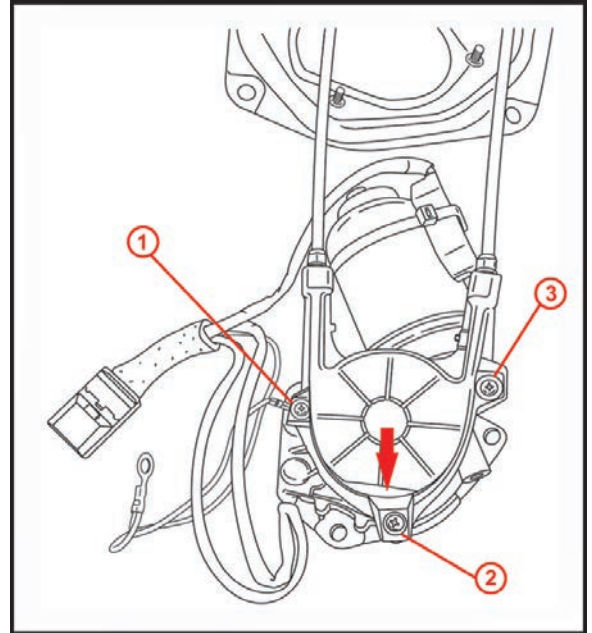

<b>1</b>	<b>Screw "A"</b>
<b>2</b>	<b>Screw "B"</b>
<b>3</b>	<b>Screw "C"</b>



## Power Function of Sliding Door Inoperative

---

### Repair Procedure (Continued)

11. Push to install the motor sub-assembly onto the actuator cover.

**Figure 11.**

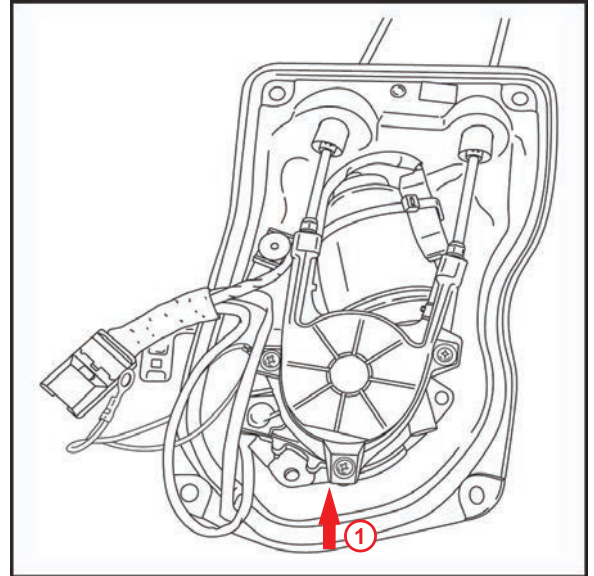

<b>1</b>	<b>Push</b>
----------	-------------

12. Reinstall the motor onto the slide motor assembly with the three nuts.

**Torque: 5.4 N\*m (540 kgf\*cm, 48 in\*lbf)**

**Figure 12.**

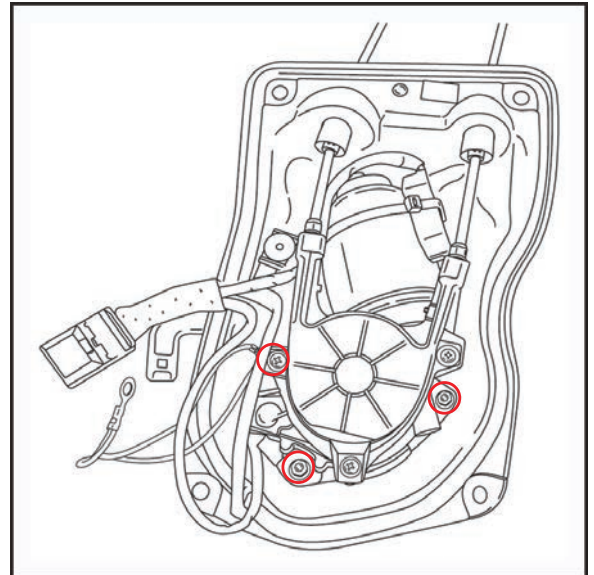

## Power Function of Sliding Door Inoperative

---

### Repair Procedure (Continued)

13. Reinstall the connector onto the bracket.

**Figure 13.**

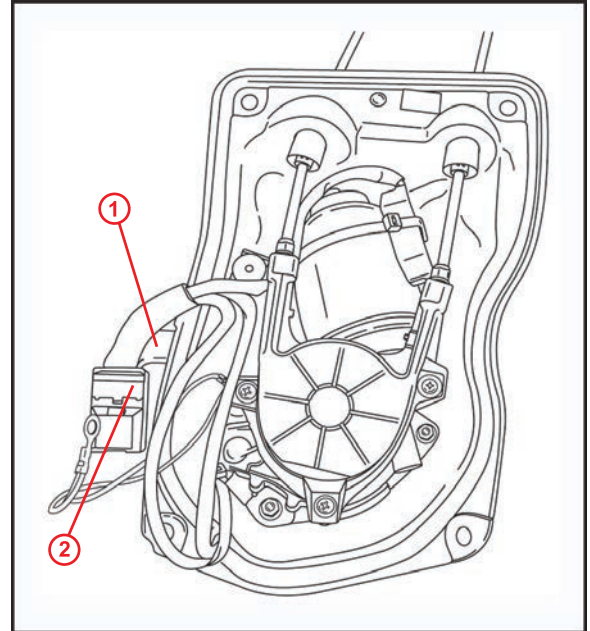

<b>1</b>	<b>Bracket</b>
<b>2</b>	<b>Connector</b>

14. Reinstall the assembly onto the door.

Refer to TIS, applicable model and model year Repair Manual:

- [2004](#) / [2005](#) Sienna:  
*Vehicle Exterior – Door/Hatch – “Power Slide Door: Overhaul”*
- [2006](#) / [2007](#) Sienna:  
*Vehicle Exterior – Door/Hatch – “Engine Hood/Door: Power Slide Door: Reassembly”*
- [2008](#) / [2009](#) / [2010](#) Sienna:  
*Vehicle Exterior – Door/Hatch – “Engine Hood/Door: Slide Door (w/Power Slide Door): Reassembly”*

15. Reinitialize the sliding door.
16. Confirm the sliding door operation.