

Rear Brake Squeak

Service Category Brake

Section Brake (rear)

Market USA

Toyota Supports
 ASE Certification 

Applicability

YEAR(S)	MODEL(S)	ADDITIONAL INFORMATION
2007 – 2008	Camry, Camry HV	Body Type(s): 4Dr. Sedan

TSB SUPERSESSION NOTICE

The information contained in this TSB supersedes TSB No. BR007-07.

- The TSB title has been modified.
- The Introduction has been updated.
- The OFP numbers and T2 code have been updated in the Warranty Information table.
- Previous part numbers have been updated in the Parts Information table.
- Repair Procedure:
 - An illustration (Figure 2) has been added to step 2.E.
 - The Note in step 2.I.(1) has been updated.
 - Figures 1 and 3 have been updated.
 - The torque specification in step 2.K. has been revised.

TSB No. BR007-07 is Obsolete and any printed versions should be discarded. Be sure to review the entire content of this service bulletin before proceeding.

Introduction

Some 2007 – 2008 model year Camry and Camry HV customers may experience rear brake noise when moving slowly (less than 10 mph [16 km/h]) with low pressure applied to the brake pedal (especially noticeable when moving in reverse). Use the following procedure to address customer concerns.

Rear Brake Squeak

Introduction (Continued)

Figure 1. NEW Rear Brake Pad

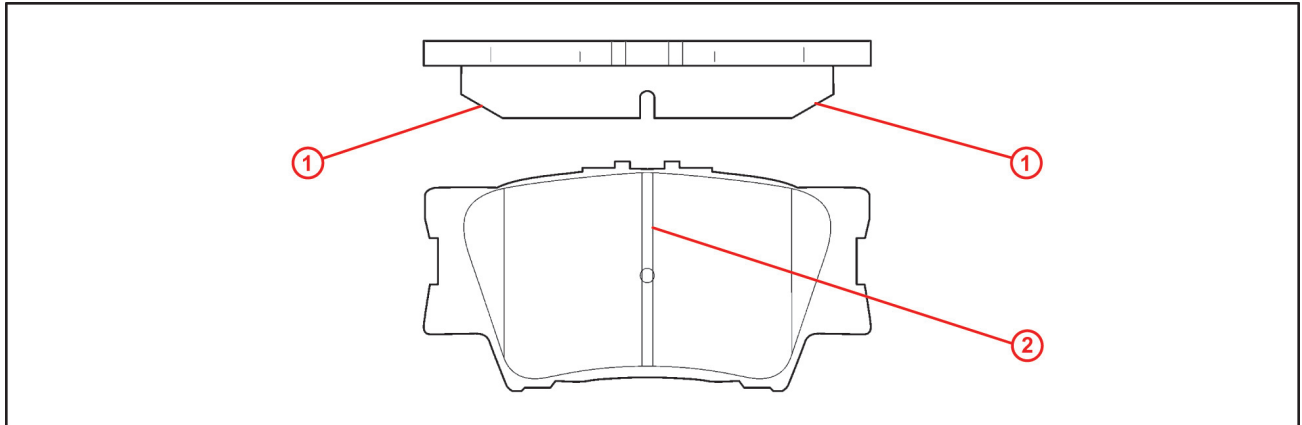

1 Added Chamfer

2 Groove Added Across Pad Surface

Warranty Information

OP CODE	DESCRIPTION	TIME	OFF	T1	T2
473311	Rear Disc Brake Pad and/or Disc Brake Pad Shim (Both Sides)	0.7	04466-06060 04466-33160	36	99

APPLICABLE WARRANTY

- This repair is covered under the Toyota Comprehensive Warranty. This warranty is in effect for 36 months or 36,000 miles, whichever occurs first, from the vehicle's in-service date.
- Warranty application is limited to correction of a problem based upon a customer's specific complaint.

Production Change Information

This TSB applies to vehicles produced **BEFORE** the Production Change Effective VINs shown below.

MODEL	PLANT	PRODUCTION CHANGE EFFECTIVE VIN
Camry	Tsutsumi	JTNBE46K#83142918
		JTNBK46K#83034303
	TMMK Plant 1	4T1BK46K#8U059298
		4T1BE46K#8U217321
	TMMK Plant 2	4T1BK46K#8U564056
		4T1BE46K#8U749621
	SIA	4T4BE46K#8R018581

Rear Brake Squeak

Production Change Information (Continued)

MODEL	PLANT	PRODUCTION CHANGE EFFECTIVE VIN
Camry HV	Tsutsumi	JTNBB46K#83047242
	TMMK	4T1BB46K#8U040940

Parts Information

PREVIOUS PART NUMBER	CURRENT PART NUMBER	PART NAME	QTY
04466-06060	04466-06090	Pad Kit, Disc Brake, Rear	1
04948-06030	04948-06031	Fitting Kit, Disc Brake, Rear	1
04948-33040			
N/A	08887-80609	Disc Brake Caliper Grease (50 g Tube)	1
04946-06070	04946-06070	Shim Kit (If Needed)	1
04946-33040			

Repair Procedure

1. Conduct a road test to verify the rear brake squeak.
 The condition usually occurs when backing up during light brake pedal pressure.
2. Remove and replace the rear disc brake pad support plate (2 per each rear caliper), the rear disc brake pads, and/or anti-squeal shims.

NOTE
 Use the same procedures for the RH side and LH side.

- A. Remove the rear wheel.
- B. Remove the rear disc brake caliper assembly by holding the 2 rear disc brake caliper slide pins and removing the 2 bolts.
- C. Remove the 2 rear disc brake pads with the anti-squeal shims.
- D. Remove the 2 anti-squeal shims and the 2 pad wear indicator plates from each pad.

Rear Brake Squeak

Repair Procedure (Continued)

E. Remove the No. 1 rear disc brake pad support plate.

- (1) Remove the No. 1 rear disc brake pad support plate from the rear disc brake caliper mounting.
- (2) Clean the area where the support plate sits with a clean shop towel.

Figure 2.

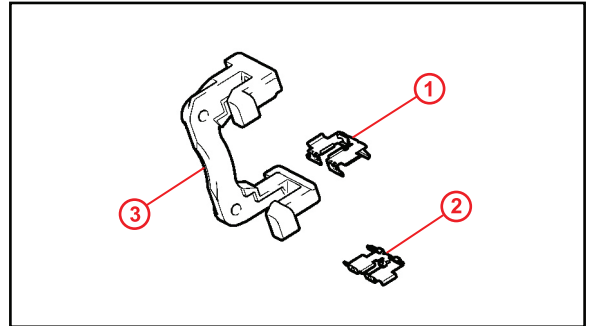

1	No. 1 Rear Disc Brake Pad Support Plate
2	No. 2 Rear Disc Brake Pad Support Plate
3	Rear Disc Brake Caliper Mounting

F. Remove the No. 2 rear disc brake pad support plate.

- (1) Remove the No. 2 rear disc brake pad support plate from the rear disc brake caliper mounting.
- (2) Clean the area where the support plate sits with a clean shop towel.

G. Install the No. 1 rear disc brake pad support plate to the rear disc brake caliper mounting.

H. Install the No. 2 rear disc brake pad support plate to the rear disc brake caliper mounting.

Rear Brake Squeak

Repair Procedure (Continued)

I. Install the rear anti-squeal shim kit.

(1) Apply disc brake grease to the inside of the anti-squeal shims (area "1" in Figure 3).

NOTE

- It is OK for disc brake grease to come out slightly from the area where the anti-squeal shim is installed.
- Make sure that disc brake grease is NOT applied onto the lining surface.

(2) Install the 2 anti-squeal shims and the pad wear indicators to each of the 2 brake pads.

NOTE

Install the pad wear indicator and anti-squeal shims in the correct positions.

(3) Apply a small amount of the disc brake grease (1 – 2 mm [0.04 – 0.08 in.] thick) to the areas indicated by "2" in Figure 3.

NOTE

Do NOT apply grease to the friction surfaces of the brake pads or the disc rotor.

Figure 3.

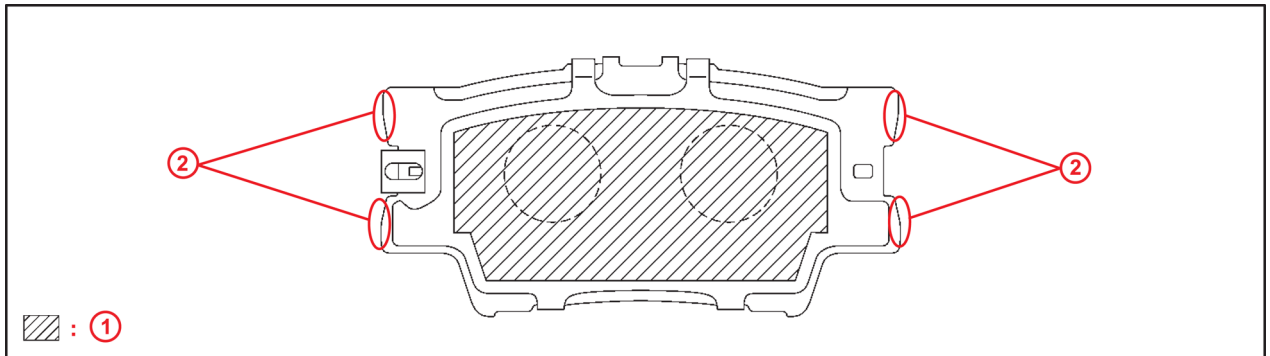

1	Apply Disc Brake Grease in this Area (approximately 1 mm [0.04 in.] thick)
2	Apply Disc Brake Grease in this Area (approximately 1 – 2 mm [0.04 – 0.08 in.] thick)

Rear Brake Squeak

Repair Procedure (Continued)

- J. Install the 2 rear disc brake pads with anti-squeal shim kit.
- K. Install the rear disc brake caliper assembly with the 2 bolts.
Torque: 27 N*m (275 kgf*cm, 20 ft*lbf)

NOTE

Do NOT twist the brake hose when installing the rear disc brake caliper assemblies.

- L. Install the rear wheel.
3. Road test the vehicle to confirm the condition has been corrected.